

Customer Care Solutions

RH-19 Cellular Phone

2 - Parts List & Layouts



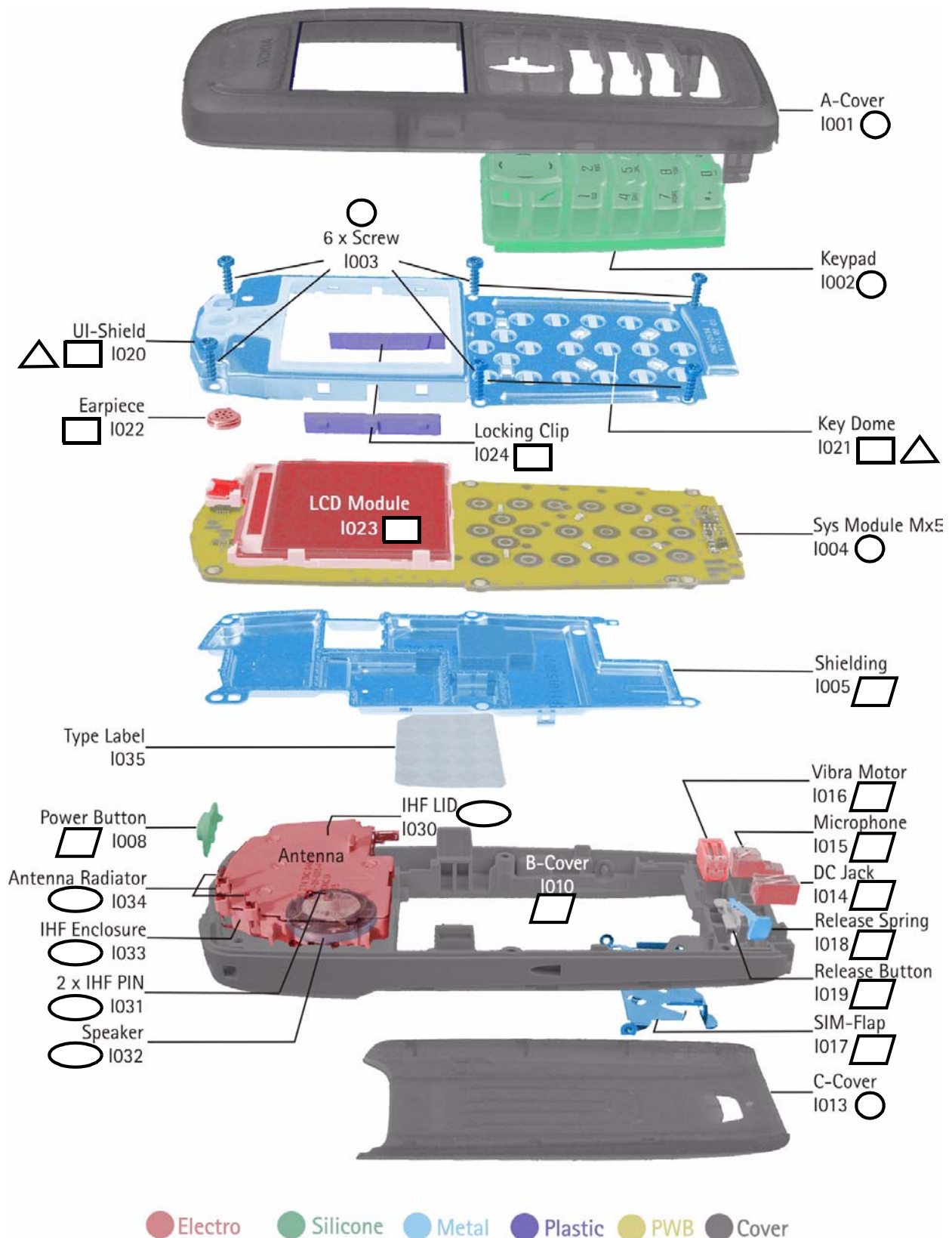

Table of Contents

	Page No
Mechanical Parts of Nokia RH-19, 3100	3
Assembly Parts List	4
Parts List PWB Module for RH-19	5
PWB Mx5 Components	5
Component layout diagram Top	22
Component layout diagram Bottom	23

Mechanical Parts of Nokia RH-19, 3100



Assembly Parts List

Item	Description	NMP code	PWB Item
			
I001	A-cover assy DMC06433, white	9459929	
I002	Keypad latin DMC06505	9791085	
I003	Screw RF 1,8x6 DMD06930	6290119	
I004	PWB MX5	xxxxxxx	
I012	BR-5C Battery Pack DMC10417	xxxxxxx	
I013	C-cover DMD10532, white	9453352	
	B-cover assembly DMC06434	9453312	
I005	Shielding assembly DMC04605	9510919	
I008	Power button DMD10533	9453311	
I010	B-Cover DMD10531	9453273	
I014	DC-plug DNS04930	5400243	X102
I015	Microphone DNC05371	5140265	B101
I016	Vib motor assy	6800069	M300
I017	SIM-flap DMD08487	9560199	
I018	C-cover release spring DMD08481	9510935	
I019	C-cover release button DMD10535	9453272	
	UI module DMC06354	9498010	
	UI-shield key dome assy HDG12	9491669	
	I020 UI-shield assy DMC06295	xxxxxxx	
	I021 Key dome assy DMC06521	xxxxxxx	
I022	Speaker pico DNS04636	5140251	B300
I023	LCD module	xxxxxxx	
I024	Locking clip DMD08699	xxxxxxx	
	Antenna assy DMC04605	0660266	
I030	IHF lid DMD08493	xxxxxxx	
I031	IHF pin DMD08352 NHL-4	xxxxxxx	
I032	IHF speaker DNS05333	xxxxxxx	B301
I033	IHF enclosure DMD08492	xxxxxxx	
I034	Antenna radiator DMD08497	xxxxxxx	
I035	Type Label	Various	

Parts List PWB Module for NPL-2

PWB Mx5 Components

Item	Product Code	Location				Description and value			Type	HWID			
		Side & Grid ref.		27 01	27 02					27 03	27 04		
B200	4510303	Bot-tom	M			6	CRYSTAL 32.768KHZ +-30PPM 9PF	32.768kHz	~			CRYSTAL_CX_4V	
B601	4510337	Bot-tom	H	3	CRYSTAL 26.0MHZ +-8PPM CL=15.5	26MHz	~	CRYSTAL_TSX_8A					
C100	2320546	Bot-tom	F	8	Chipcap 5% NPO	27p 50V	normal,-5%,5%	0402C					
C101	2320481	Top	T	6	CHIPCAP X5R 1U K 6V3	1u0 6.3V	normal,-10%,10%	0603C					
C102	2320481	Top	T	8	CHIPCAP X5R 1U K 6V3	1u0 6.3V	normal,-10%,10%	0603C					
C103	2321013	Bot-tom	R	8	CHIPCAP NPO 270P J 25V	270p 25V	normal,-5%,5%	0402C					
C104	2320544	Bot-tom	R	8	Chipcap 5% NPO	22p 50V	normal,-5%,5%	0402C					
C105	2320544	Bot-tom	R	7	Chipcap 5% NPO	22p 50V	normal,-5%,5%	0402C					
C106	2320744	Top	T	6	Chipcap X7R 10% 50V	1n0 50V	normal,-10%,10%	0402C					
C107	2320778	Top	T	8	Chipcap X7R 10% 16V	10n 16V	normal,-10%,10%	0402C					
C108	2320778	Top	T	7	Chipcap X7R 10% 16V	10n 16V	normal,-10%,10%	0402C					
C109	2320778	Top	T	8	Chipcap X7R 10% 16V	10n 16V	normal,-10%,10%	0402C					
C110	2320544	Top	T	6	Chipcap 5% NPO	22p 50V	normal,-5%,5%	0402C					
C111	2320778	Top	T	8	Chipcap X7R 10% 16V	10n 16V	normal,-10%,10%	0402C					
C113	2320778	Top	T	7	Chipcap X7R 10% 16V	10n 16V	normal,-10%,10%	0402C					
C150	2320481	Bot-tom	0	7	CHIPCAP X5R 1U K 6V3	1u0 6.3V	normal,-10%,10%	0603C					
C151	2320744	Bot-tom	0	7	Chipcap X7R 10% 50V	1n0 50V	normal,-10%,10%	0402C					
C152	2320481	Bot-tom	0	7	CHIPCAP X5R 1U K 6V3	1u0 6.3V	normal,-10%,10%	0603C					
C153	2320783	Bot-tom	N	7	CHIPCAP X7R 33N K 10V	33n 10V	normal,-20%,20%	0402C					
C154	2320544	Bot-tom	S	4	Chipcap 5% NPO	22p 50V	normal,-5%,5%	0402C					
C155	2320783	Bot-tom	N	6	CHIPCAP X7R 33N K 10V	33n 10V	normal,-10%,10%	0402C					
C156	2320544	Top	T	8	Chipcap 5% NPO	22p 50V	normal,-10%,10%	0402C					
C157	2320544	Top	T	8	Chipcap 5% NPO	22p 50V	normal,-10%,10%	0402C					
C158	2320805	Bot-tom	N	7	CHIPCAP X5R 100N K 10V	100n 10V	normal,-10%,10%	0402C					
C159	2320783	Bot-tom	N	7	CHIPCAP X7R 33N K 10V	33n 10V	normal,-20%,20%	0402C					

Item	Product Code	Location			Description and value	Type	HWID				
		Side	Et	Grid ref.			27 01	27 02	27 03	27 04	
C160	2320544	Bot- tom	N	7	Chipcap 5% NP0 22p 50V	normal,-5%,5%	0402C				
C161	2320744	Bot- tom	N	7	Chipcap X7R 10% 50V 1n0 50V	normal,-10%,10%	0402C				
C162	2320805	Bot- tom	N	7	CHIPCAP X5R 100N K 10V	normal,-10%,10%	0402C				
C163	2320481	Bot- tom	0	7	CHIPCAP X5R 1U K 6V3 1u0 6.3V	normal,-10%,10%	0603C				
C164	2320544	Bot- tom	N	6	Chipcap 5% NP0 22p 50V	normal,-5%,5%	0402C				
C165	2320544	Bot- tom	N	6	Chipcap 5% NP0 22p 50V	normal,-5%,5%	0402C				
C166	2320783	Bot- tom	0	8	CHIPCAP X7R 33N K 10V 33n 10V	normal,-20%,20%	0402C				
C167	2320481	Bot- tom	0	6	CHIPCAP X5R 1U K 6V3 1u0 6.3V	normal,-10%,10%	0603C				
C168	2320805	Bot- tom	0	6	CHIPCAP X5R 100N K 10V	normal,-10%,10%	0402C				
C169	2320544	Bot- tom	0	6	Chipcap 5% NP0 22p 50V	normal,-5%,5%	0402C				
C170	2320783	Bot- tom	N	8	CHIPCAP X7R 33N K 10V 33n 10V	normal,-20%,20%	0402C				
C171	2320744	Bot- tom	N	7	Chipcap X7R 10% 50V 1n0 50V	normal,-10%,10%	0402C				
C172	2320744	Bot- tom	N	8	Chipcap X7R 10% 50V 1n0 50V	normal,-10%,10%	0402C				
C173	2320744	Bot- tom	N	8	Chipcap X7R 10% 50V 1n0 50V	normal,-10%,10%	0402C				
C174	2320744	Bot- tom	0	8	Chipcap X7R 10% 50V 1n0 50V	normal,-10%,10%	0402C				
C175	2320481	Bot- tom	0	8	CHIPCAP X5R 1U K 6V3 1u0 6.3V	normal,-10%,10%	0603C				
C176	2320481	Bot- tom	0	8	CHIPCAP X5R 1U K 6V3 1u0 6.3V	normal,-10%,10%	0603C				
C177	2320552	Bot- tom	E	3	Chipcap 5% NP0 47p 50V	normal,-5%,5%	0402C				
C178	2320552	Bot- tom	E	3	Chipcap 5% NP0 47p 50V	normal,-5%,5%	0402C				
C179	2320544	Bot- tom	M	6	Chipcap 5% NP0 22p 50V	normal,-5%,5%	0402C				
C180	2320544	Bot- tom	M	6	Chipcap 5% NP0 22p 50V	normal,-5%,5%	0402C				
C181	2320544	Bot- tom	0	8	Chipcap 5% NP0 22p 50V	normal,-5%,5%	0402C				
C182	2320544	Bot- tom	0	8	Chipcap 5% NP0 22p 50V	normal,-5%,5%	0402C				

Item	Product Code	Location			Description and value	Type	HWID			
		Side	Et	Grid ref.			27 01	27 02	27 03	27 04
C183	2320481	Bot- tom	O	8	CHIPCAP X5R 1U K 6V3 1u0 6.3V normal,-10%,10%	0603C	NA	NA	NA	NA
C185	2320744	Bot- tom	N	7	Chipcap X7R 10% 50V 1n0 50V normal,-10%,10%	0402C				
C186	2320481	Bot- tom	O	7	CHIPCAP X5R 1U K 6V3 1u0 6.3V normal,-10%,10%	0603C	NA	NA	NA	NA
C187	2320744	Bot- tom	N	7	Chipcap X7R 10% 50V 1n0 50V normal,-10%,10%	0402C				
C200	2320805	Bot- tom	L	7	CHIPCAP X5R 100N K 10V 100n 10V normal,-10%,10%	0402C				
C201	2320481	Bot- tom	K	6	CHIPCAP X5R 1U K 6V3 1u0 6.3V normal,-10%,10%	0603C				
C202	2320778	Bot- tom	K	6	Chipcap X7R 10% 16V 10n 16V normal,-10%,10%	0402C				
C203	2320481	Bot- tom	N	9	CHIPCAP X5R 1U K 6V3 1u0 6.3V normal,-10%,10%	0603C				
C204	2320481	Bot- tom	K	6	CHIPCAP X5R 1U K 6V3 1u0 6.3V normal,-10%,10%	0603C				
C205	2320481	Bot- tom	L	6	CHIPCAP X5R 1U K 6V3 1u0 6.3V normal,-10%,10%	0603C				
C206	2320481	Bot- tom	L	6	CHIPCAP X5R 1U K 6V3 1u0 6.3V normal,-10%,10%	0603C				
C207	2320481	Bot- tom	M	9	CHIPCAP X5R 1U K 6V3 1u0 6.3V normal,-10%,10%	0603C				
C208	2320481	Bot- tom	K	6	CHIPCAP X5R 1U K 6V3 1u0 6.3V normal,-10%,10%	0603C				
C209	2320536	Bot- tom	M	6	Chipcap 5% NP0 10p 50V normal,-5%,5%	0402C				
C210	2320536	Bot- tom	N	6	Chipcap 5% NP0 10p 50V normal,-5%,5%	0402C				
C211	2320481	Bot- tom	M	6	CHIPCAP X5R 1U K 6V3 0603 1u0 6.3V normal,-10%,10%	0603C				
C212	2320481	Bot- tom	P	6	CHIPCAP X5R 1U K 6V3 0603 1u0 6.3V normal,-10%,10%	0603C				
C213	2320481	Bot- tom	L	6	CHIPCAP X5R 1U K 6V3 0603 1u0 6.3V normal,-10%,10%	0603C				
C214	2320481	Bot- tom	L	6	CHIPCAP X5R 1U K 6V3 0603 1u0 6.3V normal,-10%,10%	0603C				
C215	2320481	Bot- tom	N	8	CHIPCAP X5R 1U K 6V3 1u0 6.3V normal,-10%,10%	0603C				
C218	2320805	Bot- tom	K	9	CHIPCAP X5R 100N K 10V 100n 10V normal,-10%,10%	0402C				
C219	2320481	Bot- tom	K	7	CHIPCAP X5R 1U K 6V3 1u0 6.3V normal,-10%,10%	0603C				
C220	2320778	Bot- tom	N	6	Chipcap X7R 10% 16V 10n 16V normal,-10%,10%	0402C				

Item	Product Code	Location			Description and value	Type	HWID			
		Side	& Grid ref.				27 01	27 02	27 03	27 04
C221	2320481	Bot- tom	K	7	CHIPCAP X5R 1U K 6V3 1u0 6.3V normal,-10%,10%	0603C				
C222	2320481	Bot- tom	J	7	CHIPCAP X5R 1U K 6V3 1u0 6.3V normal,-10%,10%	0603C				
C223	2320481	Bot- tom	K	7	CHIPCAP X5R 1U K 6V3 1u0 6.3V normal,-10%,10%	0603C				
C224	2320481	Bot- tom	K	8	CHIPCAP X5R 1U K 6V3 1u0 6.3V normal,-10%,10%	0603C				
C225	2320481	Bot- tom	K	8	CHIPCAP X5R 1U K 6V3 1u0 6.3V normal,-10%,10%	0603C				
C226	2320481	Bot- tom	J	8	CHIPCAP X5R 1U K 6V3 1u0 6.3V normal,-10%,10%	0603C				
C227	2320481	Bot- tom	J	8	CHIPCAP X5R 1U K 6V3 1u0 6.3V normal,-10%,10%	0603C				
C228	2320481	Bot- tom	J	9	CHIPCAP X5R 1U K 6V3 1u0 6.3V normal,-10%,10%	0603C				
C229	2320481	Bot- tom	J	8	CHIPCAP X5R 1U K 6V3 1u0 6.3V normal,-10%,10%	0603C				
C230	2320481	Bot- tom	K	8	CHIPCAP X5R 1U K 6V3 1u0 6.3V normal,-10%,10%	0603C				
C231	2320481	Bot- tom	K	9	CHIPCAP X5R 1U K 6V3 1u0 6.3V normal,-10%,10%	0603C				
C232	2320481	Bot- tom	K	8	CHIPCAP X5R 1U K 6V3 1u0 6.3V normal,-10%,10%	0603C				
C234	2320481	Bot- tom	J	8	CHIPCAP X5R 1U K 6V3 1u0 6.3V normal,-10%,10%	0603C				
C235	2320481	Bot- tom	K	9	CHIPCAP X5R 1U K 6V3 1u0 6.3V normal,-10%,10%	0603C				
C236	2320805	Bot- tom	K	9	CHIPCAP X5R 100N K 10V 100n 10V normal,-10%,10%	0402C				
C237	2320805	Bot- tom	M	7	CHIPCAP X5R 100N K 10V 100n 10V normal,-10%,10%	0402C				
C238	2320805	Bot- tom	L	6	CHIPCAP X5R 100N K 10V 100n 10V normal,-10%,10%	0402C				
C239	2320805	Bot- tom	L	9	CHIPCAP X5R 100N K 10V 100n 10V normal,-10%,10%	0402C				
C240	2320778	Bot- tom	L	10	Chipcap X7R 10% 16V 10n 16V normal,-10%,10%	0402C				
C241	2320744	Bot- tom	M	6	Chipcap X7R 10% 50V 1n0 50V normal,-10%,10%	0402C				
C242	2320744	Bot- tom	L	9	Chipcap X7R 10% 50V 1n0 50V normal,-10%,10%	0402C	NA	NA	NA	NA
C243	2320481	Bot- tom	M	6	CHIPCAP X5R 1U K 6V3 1u0 6.3V normal,-10%,10%	0603C				
C260	2320481	Bot- tom	J	8	CHIPCAP X5R 1U K 6V3 1u0 6.3V normal,-10%,10%	0603C				

Item	Product Code	Location			Description and value	Type	HWID			
		Side	Et Grid ref.				27 01	27 02	27 03	27 04
C261	2320481	Bot-tom	K	6	CHIPCAP X5R 1U K 6V3 1u0 6.3V normal,-10%,10%	0603C				
C262	2320481	Bot-tom	J	7	CHIPCAP X5R 1U K 6V3 1u0 6.3V normal,-10%,10%	0603C				
C263	2320481	Bot-tom	J	8	CHIPCAP X5R 1U K 6V3 1u0 6.3V normal,-10%,10%	0603C				
C264	2320481	Bot-tom	J	8	CHIPCAP X5R 1U K 6V3 1u0 6.3V normal,-10%,10%	0603C				
C265	2320481	Bot-tom	J	8	CHIPCAP X5R 1U K 6V3 1u0 6.3V normal,-10%,10%	0603C				
C302	2320556	Bot-tom	0	9	Chipcap 5% NP0 68p 50V normal,-5%,5%	0402C				
C303	2320481	Bot-tom	0	9	CHIPCAP X5R 1U K 6V3 1u0 6.3V normal,-10%,10%	0603C				
C304	2312411	Bot-tom	M	9	CHIPCAP X5R 1U0 M 25V 1u0 25V normal,-20%,20%	1206_BLM				
C306	2320778	Bot-tom	Q	6	Chipcap X7R 10% 16V 10n 16V normal,-10%,10%	0402C				
C310	2320544	Bot-tom	B	6	Chipcap 5% NP0 22p 50V normal,-5%,5%	0402C				
C312	2320544	Bot-tom	F	3	Chipcap 5% NP0 22p 50V normal,-5%,5%	0402C				
C313	2320544	Top	B	5	Chipcap 5% NP0 22p 50V normal,-5%,5%	0402C				
C315	2320544	Bot-tom	R	5	Chipcap 5% NP0 22p 50V normal,-5%,5%	0402C	NA	NA	NA	NA
C316	2320481	Bot-tom	R	4	CHIPCAP X5R 1U K 6V3 0603 1u0 6.3V normal,-10%,10%	0603C				
C319	2320805	Bot-tom	0	6	CHIPCAP X5R 100N K 10V 0402 100n 10V normal,-10%,10%	0402C				
C322	2320552	Bot-tom	K	9	Chipcap 5% NP0 47p 50V normal,-5%,5%	0402C	NA	NA	NA	NA
C330	2320552	Bot-tom	N	9	Chipcap 5% NP0 47p 50V normal,-5%,5%	0402C	NA	NA	NA	NA
C331	2320552	Bot-tom	N	9	Chipcap 5% NP0 47p 50V normal,-5%,5%	0402C	NA	NA	NA	NA
C390	2320805	Bot-tom	R	9	CHIPCAP X5R 100N K 10V 100n 10V normal,-10%,10%	0402C				
C391	2320552	Bot-tom	R	9	Chipcap 5% NP0 47p 50V normal,-5%,5%	0402C				
C392	2320552	Bot-tom	0	7	Chipcap 5% NP0 47p 50V normal,-5%,5%	0402C				
C393	2320544	Bot-tom	0	8	Chipcap 5% NP0 22p 50V normal,-5%,5%	0402C	NA	NA	NA	NA
C400	2320778	Bot-tom	M	6	Chipcap X7R 10% 16V 10n 16V normal,-10%,10%	0402C				

Item	Product Code	Location			Description and value	Type	HWID					
		Side	Et	Grid ref.			27 01	27 02	27 03	27 04		
C401	2320805	Bot- tom	M	6	CHIPCAP X5R 100N K 10V	100n 10V	normal,-10%,10%	0402C				
C402	2320778	Bot- tom	L	6	Chipcap X7R 10% 16V	10n 16V	normal,-10%,10%	0402C				
C403	2320778	Bot- tom	N	6	Chipcap X7R 10% 16V	10n 16V	normal,-10%,10%	0402C				
C404	2320778	Bot- tom	N	6	Chipcap X7R 10% 16V	10n 16V	normal,-10%,10%	0402C				
C405	2320778	Bot- tom	N	6	Chipcap X7R 10% 16V	10n 16V	normal,-10%,10%	0402C				
C420	2320552	Bot- tom	L	6	Chipcap 5% NP0	47p 50V	normal,-5%,5%	0402C				
C426	2320744	Bot- tom	K	6	Chipcap X7R 10% 50V	1n0 50V	normal,-10%,10%	0402C				
C450	2320778	Bot- tom	Q	6	Chipcap X7R 10% 16V	10n 16V	normal,-10%,10%	0402C				
C451	2320805	Bot- tom	Q	6	CHIPCAP X5R 100N K 10V	100n 10V	normal,-10%,10%	0402C				
C454	2320779	Bot- tom	P	6	CHIPCAP X7R 100N K 16V	100n 16V	normal,-10%,10%	0603_BLM				
C601	2320629	Bot- tom	C	5	CHIPCAP NP0 1P0 B 50V	1p0 50V	normal,-0.1p,0.1p	0402C				
C602	2320629	Bot- tom	C	4	CHIPCAP NP0 1P0 B 50V	1p0 50V	normal,-0.1p,0.1p	0402C				
C603	2320744	Bot- tom	H	4	Chipcap X7R 10% 50V	1n0 50V	normal,-10%,10%	0402C				
C605	2320805	Bot- tom	I	4	CHIPCAP X5R 100N K 10V	100n 10V	normal,-10%,10%	0402C				
C606	2320546	Bot- tom	H	4	Chipcap 5% NP0	27p 50V	normal,-5%,5%	0402C				
C607	2312211	Bot- tom	G	3	CHIPCAP X5R 3U3 K 6V3	3u3 6V3	normal,-10%,10%	0805C_H1.35				
C610	2320805	Bot- tom	L	5	CHIPCAP X5R 100N K 10V	100n 10V	normal,-10%,10%	0402C				
C611	2320516	Bot- tom	D	5	Chipcap +-0.25pF NP0	1p5 50V	normal,-0.25pF,0.25pF	0402C	NA	NA	NA	NA
C615	2320778	Bot- tom	H	4	Chipcap X7R 10% 16V	10n 16V	normal,-10%,10%	0402C				
C620	2320546	Bot- tom	G	4	Chipcap 5% NP0	27p 50V	normal,-5%,5%	0402C				
C621	2320552	Bot- tom	I	3	Chipcap 5% NP0	47p 50V	normal,-5%,5%	0402C				
C622	2320805	Bot- tom	I	4	CHIPCAP X5R 100N K 10V	100n 10V	normal,-10%,10%	0402C				
C623	2320805	Bot- tom	I	5	CHIPCAP X5R 100N K 10V	100n 10V	normal,-10%,10%	0402C				

Item	Product Code	Location			Description and value	Type	HWID				
		Side	Et	Grid ref.			27 01	27 02	27 03	27 04	
C624	2320546	Bot- tom	H	6	Chipcap 5% NPO 27p 50V	normal,-5%,5%	0402C				
C625	2320481	Bot- tom	J	5	CHIPCAP X5R 1U K 6V3 1u0 6.3V	normal,-10%,10%	0603C				
C626	2320522	Bot- tom	G	6	Chipcap +-0.25pF NPO 2p7 50V	normal,- 0.25pF,0.25pF	0402C				
C627	2313213	Bot- tom	J	3	CHIPCAP X5R 10U K 6V3 10u 6.3V	normal,-10%,10%	1206C_H1.8				
C628	2320778	Bot- tom	I	4	Chipcap X7R 10% 16V 10n 16V	normal,-10%,10%	0402C				
C629	2320546	Bot- tom	I	5	Chipcap 5% NPO 27p 50V	normal,-5%,5%	0402C				
C630	2320629	Bot- tom	G	5	CHIPCAP NPO 1P0 B 50V 1p0 50V	normal,-0.1p,0.1p	0402C				
C631	2320629	Bot- tom	G	6	CHIPCAP NPO 1P0 B 50V 1p0 50V	normal,-0.1p,0.1p	0402C				
C632	2320805	Bot- tom	H	4	CHIPCAP X5R 100N K 10V 100n 10V	normal,-10%,10%	0402C				
C633	2320546	Bot- tom	I	5	Chipcap 5% NPO 27p 50V	normal,-5%,5%	0402C				
C634	2320522	Bot- tom	G	4	Chipcap +-0.25pF NPO 2p7 50V	normal,- 0.25pF,0.25pF	0402C				
C635	2320546	Bot- tom	I	5	Chipcap 5% NPO 27p 50V	normal,-5%,5%	0402C				
C636	2320778	Bot- tom	I	4	Chipcap X7R 10% 16V 10n 16V	normal,-10%,10%	0402C				
C637	2320778	Bot- tom	I	5	Chipcap X7R 10% 16V 10n 16V	normal,-10%,10%	0402C				
C638	2320805	Bot- tom	H	6	CHIPCAP X5R 100N K 10V 100n 10V	normal,-10%,10%	0402C	NA	NA	NA	NA
C639	2320805	Bot- tom	I	5	CHIPCAP X5R 100N K 10V 100n 10V	normal,-10%,10%	0402C	NA	NA	NA	NA
C701	2320532	Bot- tom	D	4	Chipcap +-0.25pF NPO 6p8 50V	normal,- 0.25pF,0.25pF	0402C				
C702	2320532	Bot- tom	E	5	Chipcap +-0.25pF NPO 6p8 50V	normal,- 0.25pF,0.25pF	0402C				
C703	2320546	Bot- tom	D	5	Chipcap 5% NPO 27p 50V	normal,-5%,5%	0402C				
C705	2322023	Bot- tom	I	6	CHIPCAP NPO 2N2 J 16V 2n2 16V	normal,-5%,5%	0603C				
C706	2320556	Bot- tom	I	6	Chipcap 5% NPO 68p 50V	normal,-5%,5%	0402C				
C709	2320631	Bot- tom	I	6	CHIPCAP NPO 180P J 25V 180p 25V	normal,-5%,5%	0402C				
C710	2320631	Bot- tom	I	5	CHIPCAP NPO 180P J 25V 180p 25V	normal,-5%,5%	0402C				

Item	Product Code	Location				Description and value	Type	HWID				
		Side	Et	Grid	ref.			27 01	27 02	27 03	27 04	
C711	2310055	Bot- tom	J	6	CHIPCAP NPO 3N9 J 25V	3n9 25V	normal,-5%,5%	0805C_AVX				
C712	2320631	Bot- tom	K	3	CHIPCAP NPO 180P J 25V	180p 25V	normal,-5%,5%	0402C				
C715	2320556	Bot- tom	I	5	Chipcap 5% NPO	68p 50V	normal,-5%,5%	0402C				
C716	2320556	Bot- tom	I	4	Chipcap 5% NPO	68p 50V	normal,-5%,5%	0402C				
C717	2320546	Bot- tom	J	6	Chipcap 5% NPO	27p 50V	normal,-5%,5%	0402C				
C718	2320744	Bot- tom	I	6	Chipcap X7R 10% 50V	1n0 50V	normal,-10%,10%	0402C				
C720	2320635	Bot- tom	G	6	CHIPCAP NPO 0P5 C 50V	0p5 50V	normal,-0.25p,0.25p	0402C	NA	NA	NA	NA
C721	2320744	Bot- tom	G	6	Chipcap X7R 10% 50V	1n0 50V	normal,-10%,10%	0402C				
C722	2320540	Bot- tom	F	6	Chipcap 5% NPO	15p 50V	normal,-5%,5%	0402C				
C723	2320540	Bot- tom	F	6	Chipcap 5% NPO	15p 50V	normal,-5%,5%	0402C				
C724	2320151	Bot- tom	F	6	Chipcap NPO 2P7 B 50V	2p7 50V	normal,-0.1p,0.1p	0402C	NA	NA	NA	NA
C731	2320550	Bot- tom	G	6	Chipcap 5% NPO	39p 50V	normal,-5%,5%	0402C				
C734	2320524	Bot- tom	I	6	Chipcap +-0.25pF NPO	3p3 50V	normal,-0.25pF,0.25pF	0402C	NA	NA	NA	NA
C740	2312211	Bot- tom	K	5	CHIPCAP X5R 3U3 K 6V3	3u3 6V3	normal,-10%,10%	0805C_H1.35				
C741	2320635	Bot- tom	K	3	CHIPCAP NPO 0P5 C 50V	0p5 50V	normal,-0.25p,0.25p	0402C				
C742	2320532	Bot- tom	L	3	Chipcap +-0.25pF NPO	6p8 50V	normal,-0.25pF,0.25pF	0402C				
C801	2320602	Bot- tom	E	6	Chipcap +-0.25pF NPO	4p7 50V	normal,-0.25pF,0.25pF	0402C				
C802	2320546	Bot- tom	D	6	Chipcap 5% NPO	27p 50V	normal,-5%,5%	0402C				
C803	2320546	Bot- tom	C	5	Chipcap 5% NPO	27p 50V	normal,-5%,5%	0402C				
C804	2320546	Bot- tom	C	5	Chipcap 5% NPO	27p 50V	normal,-5%,5%	0402C				
C805	2320546	Bot- tom	C	5	Chipcap 5% NPO	27p 50V	normal,-5%,5%	0402C				
C807	2320520	Bot- tom	C	6	Chipcap +-0.25pF NPO	2p2 50V	normal,-0.25pF,0.25pF	0402C				
C810	2320602	Bot- tom	E	6	Chipcap +-0.25pF NPO	4p7 50V	normal,-0.25pF,0.25pF	0402C	NA	NA	NA	NA

Item	Product Code	Location			Description and value	Type	HWID				
		Side	Et Grid ref.				27 01	27 02	27 03	27 04	
C811	2320744	Bot-tom	C	6	Chipcap X7R 10% 50V 1n0 50V	normal,-10%,10%	0402C				
C812	2310793	Bot-tom	I	9	CHIPCAP X5R 2U2 K 10V 2u2 10V	normal,-10%,10%	0805C				
C813	2320524	Bot-tom	D	6	Chipcap +/-0.25pF NPO 3p3 50V	normal,-0.25pF,0.25pF	0402C				
C814	2320548	Bot-tom	C	6	Chipcap 5% NPO 33p 50V	normal,-5%,5%	0402C				
C815	2611753	Bot-tom	I	8	CHIPTCAP 33U M 16V 6.0X3.2X1.5	normal,-20%,20%	TANT_TPSW2				
C816	2320604	Bot-tom	I	9	Chipcap 5% NPO 18p 50V	normal,-5%,5%	0402C				
C817	2320602	Bot-tom	I	9	Chipcap +/-0.25pF NPO 4p7 50V	normal,-0.25pF,0.25pF	0402C				
C818	2320546	Bot-tom	D	9	Chipcap 5% NPO 27p 50V	normal,-5%,5%	0402C				
C819	2611753	Bot-tom	B	8	CHIPTCAP 33U M 16V 6.0X3.2X1.5	normal,-20%,20%	TANT_TPSW2				
C820	2320546	Bot-tom	D	9	Chipcap 5% NPO 27p 50V	normal,-5%,5%	0402C				
C821	2320518	Bot-tom	D	9	Chipcap +/-0.25pF NPO 1p8 50V	normal,-0.25pF,0.25pF	0402C				
C822	2320546	Bot-tom	E	9	Chipcap 5% NPO 27p 50V	normal,-5%,5%	0402C				
C823	2320518	Bot-tom	E	6	Chipcap +/-0.25pF NPO 1p8 50V	normal,-0.25pF,0.25pF	0402C	NA	NA	NA	NA
C824	2320526	Bot-tom	E	9	Chipcap +/-0.25pF NPO 3p9 50V	normal,-0.25pF,0.25pF	0402C				
C825	2320805	Bot-tom	E	6	CHIPCAP X5R 100N K 10V 100n 10V	normal,-10%,10%	0402C				
C826	2320805	Bot-tom	C	6	CHIPCAP X5R 100N K 10V 100n 10V	normal,-10%,10%	0402C				
C830	2320787	Bot-tom	C	9	CHIPCAP X7R 15N K 16V 15n 16V	normal,-10%,10%	0402C	NA	NA	NA	NA
C832	2320787	Bot-tom	E	9	CHIPCAP X7R 15N K 16V 15n 16V	normal,-10%,10%	0402C	NA	NA	NA	NA
C835	2320514	Bot-tom	F	9	Chipcap +/-0.25pF NPO 1p2 50V	normal,-0.25pF,0.25pF	0402C				
C836	2320524	Bot-tom	F	8	Chipcap +/-0.25pF NPO 3p3 50V	normal,-0.25pF,0.25pF	0402C				
C837	2320552	Bot-tom	F	8	Chipcap 5% NPO 47p 50V	normal,-5%,5%	0402C				
C872	2320805	Bot-tom	H	3	CHIPCAP X5R 100N K 10V 0402 100n 10V	normal,-10%,10%	0402C				
D200	4376001	Bot-tom	L	8	UEMK W-DOG ENA T021 TFBGA168	~	~				

Item	Product Code	Location		Description and value	Type	HWID				
		Side	Grid ref.			27 01	27 02	27 03	27 04	
D400	4370931	Bot- tom	N 4	UPP8M V2.2 F751986B C035	~	~				
D450	4341531	Bot- tom	P 4	COMBO 64M NOR+4M SRAM TBGA48	4Mx16/ 256kx16	~				
F100	5119019	Top	T 5	SM FUSE F 1.5A 32V 0603	1.5A	~				
G701	4350315	Bot- tom	K 4	VCO 3420-3980MHZ 2.7V 19MA	3420- 3980MHz	~	X		X	
	4350421	Bot- tom	K 4	VCO 3420-3980MHZ 2.7V 20MA GSM	3420- 3980MHz	~		X		X
L100	3203705	Top	T 5	FERRITE BEAD 42R/ 100MHZ 0805	42R/ 100MHZ	~				
L102	3203803	Top	T 7	CHIP BEAD ARRAY 2X1000R 0405	2x1000R/ 100MHZ	-				
L103	3203803	Top	T 8	CHIP BEAD ARRAY 2X1000R 0405	2x1000R/ 100MHZ	-				
L106	3203725	Top	T 6	FERRITE BEAD 0R6 600R/ 100M 0402	600R/ 100MHZ	~				
L107	3203741	Top	T 6	FERRITE BEAD 0R5 600R/ 100MHZ 0603	600R/ 100MHZ	~				
L150	3203803	Top	B 5	CHIP BEAD ARRAY 2X1000R 0405	2x1000R/ 100MHZ	-				
L151	3203769	Bot- tom	E 3	FERR.BEAD 240R7100M 0.4A 0R4 0402	240R/ 100MHZ	~				
L152	3203769	Bot- tom	E 3	FERR.BEAD 240R7100M 0.4A 0R4 0402	240R/ 100MHZ	~				
L153	3203725	Bot- tom	S 4	FERRITE BEAD 0R6 600R/ 100M 0402	600R/ 100MHZ	~				
L260	3203741	Bot- tom	I 8	FERRITE BEAD 0R5 600R/ 100MHZ 0603	600R/ 100MHZ	~				
L261	3203741	Bot- tom	K 6	FERRITE BEAD 0R5 600R/ 100MHZ 0603	600R/ 100MHZ	~				
L262	3203741	Bot- tom	I 7	FERRITE BEAD 0R5 600R/ 100MHZ 0603	600R/ 100MHZ	~				
L263	3203741	Bot- tom	I 8	FERRITE BEAD 0R5 600R/ 100MHZ 0603	600R/ 100MHZ	~				
L264	3203741	Bot- tom	I 8	FERRITE BEAD 0R5 600R/ 100MHZ 0603	600R/ 100MHZ	~				
L265	3203741	Bot- tom	I 8	FERRITE BEAD 0R5 600R/ 100MHZ 0603	600R/ 100MHZ	~				
L300	3640119	Bot- tom	N 8	CHOKE 22U M 1R4 0.33A 3.3X3.3X1.5	22uH	normal,-20%,20%				
L301	3203725	Bot- tom	R 5	FERRITE BEAD 0R6 600R/ 100M 0402	600R/ 100MHZ	~				
L302	3203741	Bot- tom	R 5	FERRITE BEAD 0R5 600R/ 100MHZ 0603	600R/ 100MHZ	~				

Item	Product Code	Location			Description and value	Type	HWID				
		Side	Et	Grid ref.			27 01	27 02	27 03	27 04	
L303	3203725	Bot-tom	R	8	FERRITE BEAD 0R6 600R/100M 0402	600R/100MHz ~	FERRITE_0402				
L601	3646087	Bot-tom	G	5	CHIP COIL 1N8+-0N3 Q31/800M 0402	1n8H normal,-0n3,0n3	0402L				
L602	3646087	Bot-tom	G	5	CHIP COIL 1N8+-0N3 Q31/800M 0402	1n8H normal,-0n3,0n3	0402L				
L603	3646005	Bot-tom	G	5	CHIP COIL 2N7+-0N3 Q29/800M 0402	2n7H normal,-0n3,0n3	0402L				
L604	3646005	Bot-tom	G	5	CHIP COIL 2N7+-0N3 Q29/800M 0402	2n7H normal,-0n3,0n3	0402L				
L606	3646055	Bot-tom	G	5	CHIP COIL 8N2 J Q28/800MHZ 0402	8n2H normal,-5%,+5%	0402L				
L607	3646055	Bot-tom	G	4	CHIP COIL 8N2 J Q28/800MHZ 0402	8n2H normal,-5%,+5%	0402L				
L608	3646051	Bot-tom	C	4	CHIP COIL 3N9 +-0N3 Q28/800M 0402	3n9H normal,-0n3,+0n3	0402L				
L705	3646131	Bot-tom	G	6	CHIP COIL 3N9 +-0N1 Q28/1GHZ 0402	3n9H normal,-0n1,+0n1	0402L_W065_POL				
L706	3646061	Bot-tom	H	6	CHIP COIL 15N J Q30/800M 0402	15nH normal,-5%,5%	0402L				
L707	3646061	Bot-tom	H	6	CHIP COIL 15N J Q30/800M 0402	15nH normal,-5%,5%	0402L				
L708	3646061	Bot-tom	H	6	CHIP COIL 15N J Q30/800M 0402	15nH normal,-5%,5%	0402L				
L710	3646043	Bot-tom	F	6	CHIP COIL 1N5 +-0N3 Q33/800M 0402	1n5H normal,-0n3,0n3	0402L	NA	NA	NA	NA
L711	3646069	Bot-tom	I	6	CHIP COIL 33N J Q23/800M 0402	33nH normal,-5%,5%	0402L				
L712	3646117	Bot-tom	F	6	CHIP COIL 5N6 +-0N1 Q26/1GHZ 0402	5n6H normal,-0n1,+0n1	0402L_H0.45	X	X		
	3646131	Bot-tom	F	6	CHIP COIL 3N9 +-0N1 Q26/1GHZ 0402	3N9H normal,-0n1,+0n1	0402L_W065_POL			X	X
L730	3646131	Bot-tom	K	5	CHIP COIL 3N9 +-0N1 Q28/1GHZ 0402	3n9H normal,-0n1,+0n1	0402L_W065_POL				
L732	3646005	Bot-tom	H	6	CHIP COIL 2N7+-0N3 Q29/800M 0402	2n7H normal,-0n3,0n3	0402L				
L733	3646005	Bot-tom	H	6	CHIP COIL 2N7+-0N3 Q29/800M 0402	2n7H normal,-0n3,0n3	0402L				
L801	4551015	Bot-tom	D	6	DIR.COUP 897.5/1747.5/1880MHZ	897.5/1747.5/1880M ~	COUPLER_LDC15D				
L802	3646047	Bot-tom	E	6	CHIP COIL 3N3 +-0N3 Q28/800M 0402	3n3H normal,-0n3,+0n3%	0402L	NA	NA	NA	NA
L804	3203705	Bot-tom	H	9	FERRITE BEAD 42R/100MHZ 0805	42R/100MHz ~	0805_FERRITE				
L805	3203705	Bot-tom	I	9	FERRITE BEAD 42R/100MHZ 0805	42R/100MHz ~	0805_FERRITE				

Item	Product Code	Location			Description and value	Type	HWID				
		Side	Et	Grid ref.			27 01	27 02	27 03	27 04	
L806	3646009	Bot- tom	D	9	CHIP COIL 10N J Q30/ 800M 0402	10nH normal,-5%,5%	0402L				
L807	3646059	Bot- tom	E	9	CHIP COIL 5N6 +-0N3 Q28/800M 0402	5n6H normal,-0n3,+0n3	0402L				
L808	3646065	Bot- tom	C	6	CHIP COIL 12N J Q31/ 800M 0402	12nH normal,-5%,5%	0402L				
L809	3646043	Bot- tom	C	6	CHIP COIL 1N5 +-0N3 Q33/800M 0402	1n5H normal,-0n3,0n3	0402L				
N100	4341063	Top	T	7	REG 2.8V/150MA LP3985 SOT23-5	~ ~	SOT23_5_H1.2				
N150	4341221	Bot- tom	O	7	AF AMP 0.4W/2.6V LM4890 USMD9	~ ~	USMD9_AAB				
N300	4341309	Bot- tom	N	9	DC/DC CONV 350MA TK11851 SSOP8	~ ~	SOT23L_8				
N601	4370867	Bot- tom	H	5	MJOELNER RF ASIC S2006 LFBGA80	~ ~	LFBGA_80				
N801	4350369	Bot- tom	D	7	PW AMP QCPM-8893 900/1800/1900MHZ	~ ~	PW_AMP_PA_HDG 13	X	X		
	4350409	Bot- tom	D	7	PW AMP PF08125B-03 GSM900/1800/ 1900MHZ	~ ~	PW_AMP_PA_HDG 13			X	X
R100	1620027	Bot- tom	R	7	RES NETWORK 0W06 2X47R J	2x47R normal,-5%,5%	0404_R_SR				
R101	1620027	Bot- tom	R	7	RES NETWORK 0W06 2X47R J	2x47R normal,-5%,5%	0404_R_SR				
R102	1620027	Bot- tom	R	7	RES NETWORK 0W06 2X47R J	2x47R normal,-5%,5%	0404_R_SR				
R103	4120011	Bot- tom	R	7	ZDIX4 IP4043CX5 CA 14V2 10W CSP5	~ ~	uBGA5				
R104	1430812	Bot- tom	R	7	Resistor 5% 63mW	220k normal,-5%,5%	0402R				
R105	1825031	Top	T	8	VARISTOR ARRAY 2XVWM16V VC50 0405	2XVWM16 V ~	0405_2				
R106	1820039	Bot- tom	O	6	NTC RES 47K J B=4050+-3% 0402	47k normal,-5%,5%	0402_NTH5				
R107	1430804	Top	T	7	Resistor 5% 63mW	100k normal,-5%,5%	0402R				
R108	1430690	Bot- tom	R	9	Chipres 0W06 jumper 0402	0R normal,-,-	0402R	NA	NA	NA	NA
R109	1430804	Bot- tom	R	8	Resistor 5% 63mW	100k normal,-5%,5%	0402R				
R110	1825031	Bot- tom	R	8	VARISTOR ARRAY 2XVWM16V VC50 0405	2XVWM16 V ~	0405_2				
R151	1825031	Top	C	5	VARISTOR ARRAY 2XVWM16V VC50 0405	2XVWM16 V ~	0405_2				
R153	1620105	Bot- tom	N	7	RES NETWORK 0W06 2X2k2 J 0404	2x2k2 ~	MNRO2				

Item	Product Code	Location			Description and value	Type	HWID				
		Side	& Grid ref.				27 01	27 02	27 03	27 04	
R155	1825031	Bot-tom	S	4	VARISTOR ARRAY 2XVWM16V VC50 0405	2XVWM16V ~	0405_2				
R156	1430762	Bot-tom	0	7	Resistor 5% 63mW	2k2 normal,-5%,5%	0402R				
R158	1430752	Bot-tom	0	9	Resistor 5% 63mW	820R normal,-5%,5%	0402R				
R159	1430754	Bot-tom	N	7	Resistor 5% 63mW	1k0 normal,-5%,5%	0402R				
R160	1430734	Bot-tom	0	7	Resistor 5% 63mW	220R normal,-5%,5%	0402R				
R162	1620105	Bot-tom	N	8	RES NETWORK 0W06 2X2k2 J 0404	2x2k2 ~	MNR02				
R163	1430786	Bot-tom	N	7	Resistor 5% 63mW	18k normal,-5%,5%	0402R				
R164	1620105	Bot-tom	N	7	RES NETWORK 0W06 2X2K2 J 0404	2x2k2 normal,-5%,5%	MNR02_SR				
R166	1430786	Bot-tom	0	7	Resistor 5% 63mW	18k normal,-5%,5%	0402R				
R167	1430778	Bot-tom	N	6	Resistor 5% 63mW	10k normal,-5%,5%	0402R				
R168	1430804	Bot-tom	0	6	Resistor 5% 63mW	100k normal,-5%,5%	0402R				
R171	1430754	Bot-tom	0	8	Resistor 5% 63mW	1k0 normal,-5%,5%	0402R				
R172	1430790	Bot-tom	N	8	Resistor 5% 63mW	27k normal,-5%,5%	0402R				
R173	1430734	Bot-tom	N	8	Resistor 5% 63mW	220R normal,-5%,5%	0402R				
R175	1430754	Bot-tom	N	8	Resistor 5% 63mW	1k0 normal,-5%,5%	0402R				
R176	1430754	Bot-tom	N	8	Resistor 5% 63mW	1k0 normal,-5%,5%	0402R				
R200	1414605	Bot-tom	K	6	CHIPRES 0W25 0R22 J 0805	0R22 normal,-5%,5%	0805R_THERM1				
R202	1620043	Bot-tom	L	9	RES NETWORK 0W03 4X100K J 0804	4x100k ~	EXB28V				
R206	1430770	Bot-tom	L	10	Resistor 5% 63mW	4k7 normal,-5%,5%	0402R				
R207	1430770	Bot-tom	N	6	Resistor 5% 63mW	4k7 normal,-5%,5%	0402R				
R300	1430712	Bot-tom	N	9	Resistor 5% 63mW	27R normal,-5%,5%	0402R				
R301	1430726	Bot-tom	N	9	Resistor 5% 63mW	100R normal,-5%,5%	0402R				
R303	1430726	Bot-tom	R	8	Resistor 5% 63mW	100R normal,-5%,5%	0402R				

Item	Product Code	Location			Description and value	Type	HWID				
		Side	& Grid ref.				27 01	27 02	27 03	27 04	
R305	1430804	Bot-tom	R	5	Resistor 5% 63mW 100k	normal,-5%,5%	0402R				
R306	1430790	Bot-tom	B	6	Resistor 5% 63mW 27k	normal,-5%,5%	0402R				
R308	1430734	Bot-tom	F	8	Resistor 5% 63mW 220R	normal,-5%,5%	0402R				
R309	1430734	Bot-tom	F	8	Resistor 5% 63mW 220R	normal,-5%,5%	0402R				
R310	1430734	Bot-tom	F	8	Resistor 5% 63mW 220R	normal,-5%,5%	0402R				
R313	1430726	Bot-tom	K	9	Resistor 5% 63mW 100R	normal,-5%,5%	0402R				
R314	1430690	Bot-tom	Q	5	Chipres 0W06 jumper 0402	normal,-,-	0402R	NA	NA	NA	NA
R315	1430790	Bot-tom	N	6	Resistor 5% 63mW 27k	normal,-5%,5%	0402R				
R316	1430812	Bot-tom	N	6	Resistor 5% 63mW 220k	normal,-5%,5%	0402R	NA	NA	NA	NA
R317	1825031	Bot-tom	S	4	VARISTOR ARRAY 2XVWM16V VC50 0405	2XVWM 16V ~	0405_2				
R318	1825031	Bot-tom	R	8	VARISTOR ARRAY 2XVWM16V VC50 0405	2XVWM 16V ~	0405_2				
R319	1430690	Bot-tom	Q	5	Chipres 0W06 jumper 0402	normal,-,-	0402R	NA	NA	NA	NA
R322	1430690	Bot-tom	J	9	Chipres 0W06 jumper 0402	normal,-,-	0402R	NA	NA	NA	NA
R324	1430762	Bot-tom	J	9	Resistor 5% 63mW 2k2	normal,-5%,5%	0402R	NA	NA	NA	NA
R388	4120071	Bot-tom	O	9	ASIP EMIF03-SIM01 SIM FILTER BGA8	~	~	uBGA8			
R420	1430754	Bot-tom	L	6	Resistor 5% 63mW 1k0	normal,-5%,5%	0402R				
R422	1430790	Bot-tom	J	9	Resistor 5% 63mW 27k	normal,-5%,5%	0402R				
R424	1430812	Bot-tom	I	4	Resistor 5% 63mW 220k	normal,-5%,5%	0402R	NA	NA	NA	NA
R426	1430754	Bot-tom	K	6	Resistor 5% 63mW 1k0	normal,-5%,5%	0402R				
R450	1430770	Bot-tom	P	6	Resistor 5% 63mW 4k7	normal,-5%,5%	0402R				
R606	1430690	Bot-tom	H	3	Chipres 0W06 jumper 0402	normal,-,-	0402R	NA	NA	NA	NA
R610	1430710	Bot-tom	H	3	Resistor 5% 63mW 22R	normal,-5%,5%	0402R				
R612	1430754	Bot-tom	H	4	Resistor 5% 63mW 1k0	normal,-5%,5%	0402R				

Item	Product Code	Location			Description and value	Type	HWID					
		Side	Et	Grid ref.			27 01	27 02	27 03	27 04		
R617	1430718	Bot-tom	I	4	Resistor 5% 63mW	47R	normal,-5%,5%	0402R				
R619	1430690	Bot-tom	I	4	Chipres 0W06 jumper 0402	0R	normal,-,-	0402R	NA	NA	NA	NA
R622	1430690	Bot-tom	I	3	Chipres 0W06 jumper 0402	0R	normal,-,-	0402R	NA	NA	NA	NA
R623	1430726	Bot-tom	I	5	Resistor 5% 63mW	100R	normal,-5%,5%	0402R				
R625	1430718	Bot-tom	I	5	Resistor 5% 63mW	47R	normal,-5%,5%	0402R				
R626	1430846	Bot-tom	H	4	Resistor 1% 63mW	2k7	normal,-1%,1%	0402R				
R627	1430690	Bot-tom	I	5	Chipres 0W06 jumper 0402	0R	normal,-,-	0402R	NA	NA	NA	NA
R628	1430693	Bot-tom	I	6	Chipres 0W06 5R6 J 0402	5R6	normal,-5%,5%	0402R				
R629	1430693	Bot-tom	I	5	Chipres 0W06 5R6 J 0402	5R6	normal,-5%,5%	0402R				
R630	1430718	Bot-tom	I	4	Resistor 5% 63mW	47R	normal,-5%,5%	0402R				
R701	1430690	Bot-tom	G	4	Chipres 0W06 jumper 0402	0R	normal,-,-	0402R	NA	NA	NA	NA
R702	1430690	Bot-tom	G	4	Chipres 0W06 jumper 0402	0R	normal,-,-	0402R	NA	NA	NA	NA
R703	1430690	Bot-tom	G	4	Chipres 0W06 jumper 0402	0R	normal,-,-	0402R	NA	NA	NA	NA
R705	1430690	Bot-tom	I	6	Chipres 0W06 jumper 0402	0R	normal,-,-	0402R	NA	NA	NA	NA
R706	1430792	Bot-tom	I	6	Resistor 5% 63mW	33k	normal,-5%,5%	0402R				
R707	1430778	Bot-tom	I	6	Resistor 5% 63mW	10k	normal,-5%,5%	0402R				
R708	1430770	Bot-tom	I	6	Resistor 5% 63mW	4k7	normal,-5%,5%	0402R				
R709	1430762	Bot-tom	C	5	Resistor 5% 63mW	2k2	normal,-5%,5%	0402R	NA	NA	NA	NA
R710	1430865	Bot-tom	J	5	CHIPRES 0W06 5K6 F 0402	5k6	normal,-1%,1%	0402R				
R711	1430776	Bot-tom	K	3	Resistor 5% 63mW	8k2	normal,-5%,5%	0402R				
R713	1620065	Bot-tom	J	5	RES NETWORK 0W06 4X5K6 J 0804	4x5.6k	normal,-5%,5%	MNR04				
R717	1620105	Bot-tom	J	6	RES NETWORK 0W06 2X2K2 J 0404	2x2k2	normal,-5%,5%	MNR02_SR				
R718	1430778	Bot-tom	I	6	Resistor 5% 63mW	10k	normal,-5%,5%	0402R	NA	NA	NA	NA

Item	Product Code	Location			Description and value	Type	HWID					
		Side	Et	Grid ref.			27 01	27 02	27 03	27 04		
R720	1430730	Bot- tom	G	6	Resistor 5% 63mW 150R	normal,-5%,5%	0402R					
R721	1430730	Bot- tom	G	6	Resistor 5% 63mW 150R	normal,-5%,5%	0402R					
R725	1430724	Bot- tom	H	6	Resistor 5% 63mW 82R	normal,-5%,5%	0402R					
R726	1430724	Bot- tom	H	6	Resistor 5% 63mW 82R	normal,-5%,5%	0402R					
R729	1620507	Bot- tom	E	9	RES NETWORK 0W04 3DB ATT 0404	292R/ 17R6/292R	~	0404_RAC10				
R731	1620507	Bot- tom	K	5	RES NETWORK 0W04 3DB ATT 0404	292R/ 17R6/292R	~	0404_RAC10				
R801	1430770	Bot- tom	D	5	Resistor 5% 63mW 4k7	normal,-5%,5%	0402R					
R802	1430726	Bot- tom	C	5	Resistor 5% 63mW 100R	normal,-5%,5%	0402R					
R803	1430718	Bot- tom	E	6	Resistor 5% 63mW 47R	normal,-5%,5%	0402R					
R804	1430690	Bot- tom	C	5	Chipres 0W06 jumper 0402	0R	normal,-,-	0402R	NA	NA	NA	NA
R805	1620517	Bot- tom	C	9	RES NETWORK 0W04 6DB ATT 0404	150R/ 37R4/150R	~	0404_RAC10				
R817	1430754	Bot- tom	C	9	Resistor 5% 63mW 1k0	normal,-5%,5%	0402R					
R818	1430726	Bot- tom	D	9	Resistor 5% 63mW 100R	normal,-5%,5%	0402R					
R819	1620507	Bot- tom	E	9	RES NETWORK 0W04 3DB ATT 0404	292R/ 17R6/292R	~	0404_RAC10				
R820	1430754	Bot- tom	D	9	Resistor 5% 63mW 1k0	normal,-5%,5%	0402R					
R821	1430726	Bot- tom	E	9	Resistor 5% 63mW 100R	normal,-5%,5%	0402R					
R822	1430766	Bot- tom	E	9	Resistor 5% 63mW 3k9	normal,-5%,5%	0402R					
R823	1430732	Bot- tom	E	10	Resistor 5% 63mW 180R	normal,-5%,5%	0402R					
R831	1430690	Bot- tom	C	5	Chipres 0W06 jumper 0402	0R	normal,-,-	0402R	NA	NA	NA	NA
R832	1430690	Bot- tom	C	5	Chipres 0W06 jumper 0402	0R	normal,-,-	0402R	NA	NA	NA	NA
S302	5200025	Bot- tom	B	6	SM TACT SW SIDE TRAVEL 0.2MM	~	~	SWITCH_SKRE				
T701	4550191	Bot- tom	F	6	TRANSF BALUN 1800+- 100MHZ 2X1.25	~	~	TRANS_LDB213				
T702	4550179	Bot- tom	I	6	BALUN TRANS 3.7GHZ+/ -300MHZ 0805	~	~	TRANS_LDB15				

Item	Product Code	Location			Description and value	Type	HWID					
		Side	Et	Grid ref.			27 01	27 02	27 03	27 04		
V100	4113721	Top	T	5	TVS DI 1PMT16AT3 16V 175W PWRMITE	~	~	CASE_457				
V300	4110479	Bottom	N	9	SCH DI 1PS79SB31 200MA 30V SOD523	~	~	SC79				
V310	4864577	Top	R	5	LED SML512WBC2WT86N 0603	~	~	LED_CL191				
V311	4864577	Top	R	7	LED SML512WBC2WT86N 0603	~	~	LED_CL191				
V318	4864577	Top	O	5	LED SML512WBC2WT86N 0603	~	~	LED_CL191				
V319	4864577	Top	O	7	LED SML512WBC2WT86N 0603	~	~	LED_CL191				
V322	4864577	Top	L	5	LED SML512WBC2WT86N 0603	~	~	LED_CL191				
V323	4864577	Top	L	8	LED SML512WBC2WT86N 0603	~	~	LED_CL191				
V801	4115821	Bottom	C	5	SCHDIX2 HSMS282C 15V <1PF SOT323	~	~	SOT323_H1.1				
V802	4210171	Bottom	D	9	TR NE68119 ***RESERVED HDB12***	~	~	SC75				
X101	5460061	Bottom	T	7	SM SYSTEM CONNECTOR 14POL	~	~	SYSCON_MQ202_NK_14R3				
X103	5409253	Bottom	G	8	SM BATTERY CONN 3POL SPR 12V 2A	~	~	LYNX_BATT_CONN				
X302	5469175	Top	B	8	SM CONN BTB 2X5 F P0.5	~	~	CON_DF23C_10DS				
X387	5409219	Bottom	Q	8	SM WIM CONNECTOR 6POL P2.54	~	~	SIM_91485_0001				
Z601	4510385	Bottom	E	5	DIPL+3XSW 880-960/1710-1990MHZ 7X5	880-960/1710-1990MHz	~	ANT_SW_KH				
Z602	4511313	Bottom	F	6	SAW FILT 1842.5+-37.5MHZ 2.5X2.0	1842.5MHz	~	FILTER_SAW_SAFSD				
Z603	4511367	Bottom	F	5	SAW FILT 1960+-30MHZ 4DB 2.0X2.5	1960MHz	~	FILTER_SAW_DCS6l_H1.1				
Z604	4511279	Bottom	F	4	SAW FILT 942.5+-17.5MHZ/3.5 2.5X2	942.5MHz	~	FILTER_SAW_SAFSD				
Z701	4511311	Bottom	H	6	SAW FILT 897.5+-17.5MHZ/3.5 2.5X2	897.5MHz	~					

Component layout diagram Top

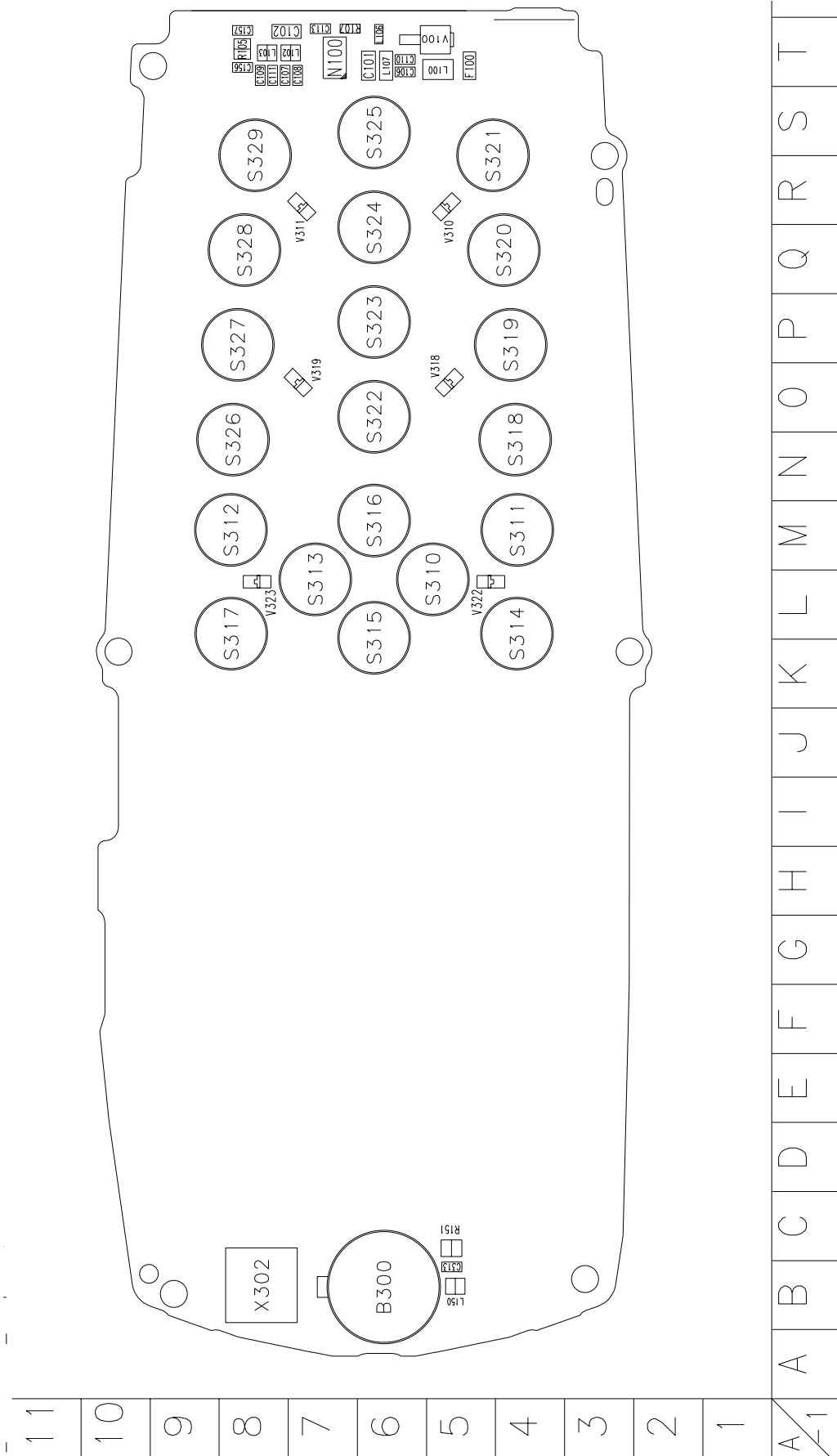

Component layout diagram Bottom

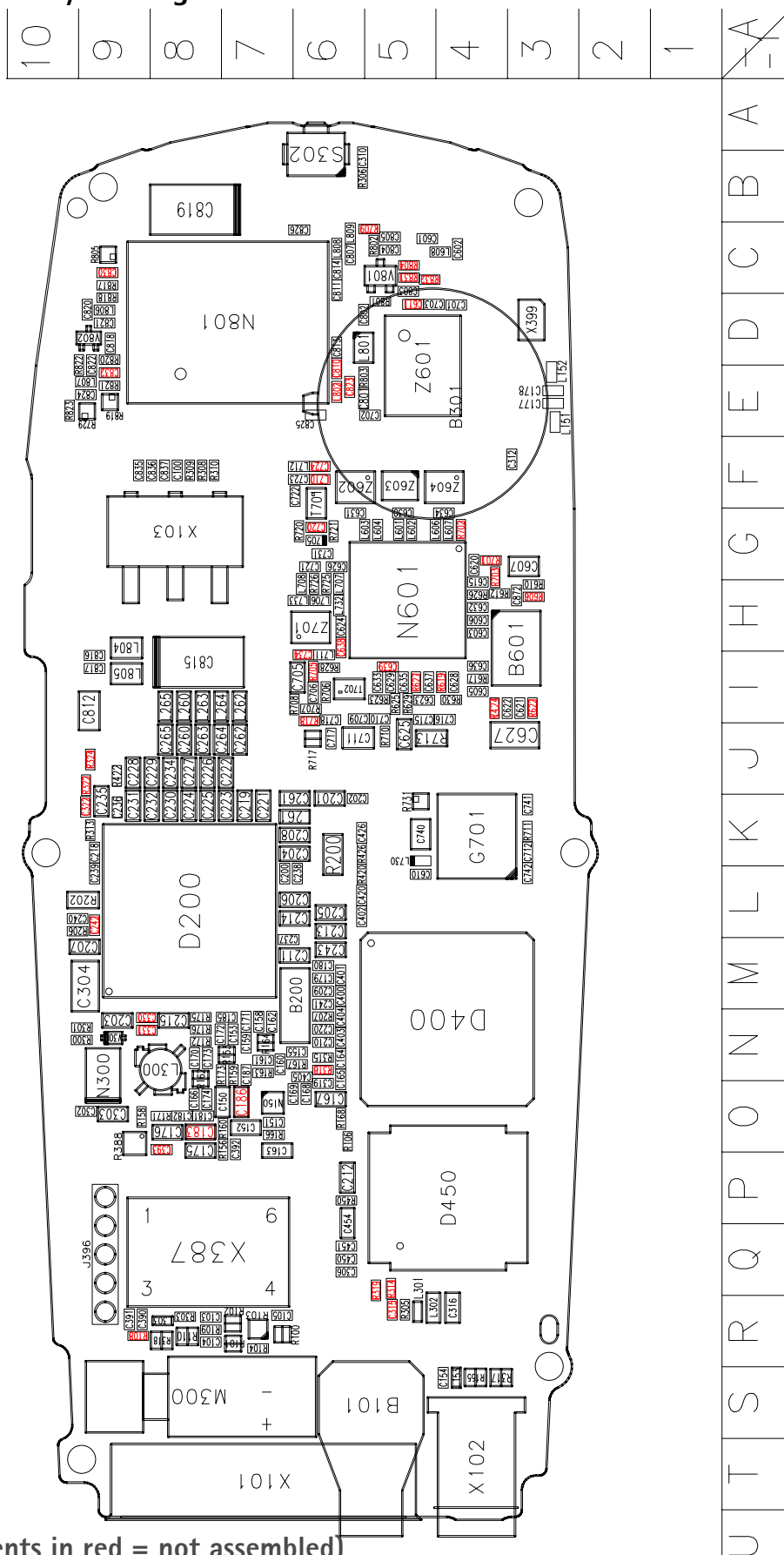

This page has been intentionally left blank